

ANNUAL SNOWFLAKE FAIR 2024 CRAFTER APPLICATION

Groveland Congregational Church
4 King St., Groveland, MA 01834 978-372-3463

Friday, November 8, 4-8 PM & Saturday, November 9, 2024, 9 AM - 3 PM

We will accept applications only for crafters who are selling their own handmade items or those of a friend/family member. Crafters who resell wholesale purchased crafts or who sell non-handmade items will not be accepted (any exceptions will be made per the fair team in advance). We will jury as much as possible.

Spaces include an 8' table and 2 chairs. However, there are several tables that are 6' (see layout). Not all spaces have access to electric outlets; please specify if you need one. Crafters will be responsible for setting up displays. Please let us know if you prefer to use your own set up that uses the same amount of space (approximately 8' x 3'). **I will let you know if you are accepted into the fair but may not release specific assignments until August 20. If it looks like I need to assign you somewhere other than your choices, you may hear from me sooner.**

Please review the layout on the back of this page. List at least 3 choices of table location that you prefer on the registration. In most cases we can accommodate your table choice. But we reserve the right to place you where we think it will be most beneficial to all involved. Just because you had a table previously does not guarantee that you will get it again. Assignment is based on when your application is received (post marked), seniority of attending the fair, and what type of craft is already placed around you when we received your application (we try not to place tables next to each other with similar items).

NEW: Instead of asking for a full payment when submitting your application, we are asking for a non-refundable registration fee of \$10. This amount will go toward the total cost of your table (if you choose to keep your table assignment). Once you receive your assignment then you can remit the remainder of your table fee. **Full payment will be due by September 20.** If I do not hear from you or receive payment by this date, your table will be made available to the next crafter on the waiting list. **There will be no refunds.**

Set up times will be listed in your confirmation mailing. Please review your confirmation assignment when you receive it to make sure the days that you requested are reserved. If there are any changes let me know as soon as possible.

Please disclose all items that you intend to sell so that we can place you appropriately (or we may ask that anything undisclosed beforehand be put away).

We will not be providing a paper covering for the front of your tables. We ask that you provide your own covers that can reach the floor in front to hide any belongings and storage.

Please be mindful of your surrounding table area. Be aware of your neighbor's space and the customers safe passage in front.

GCC will be locked overnight but is not responsible for items left in the building.

** Please post a link to the church on your website & don't forget Facebook, Twitter, Instagram & any other social media sites too!

SNOWFLAKE FAIR CRAFTERS TABLE LAYOUT

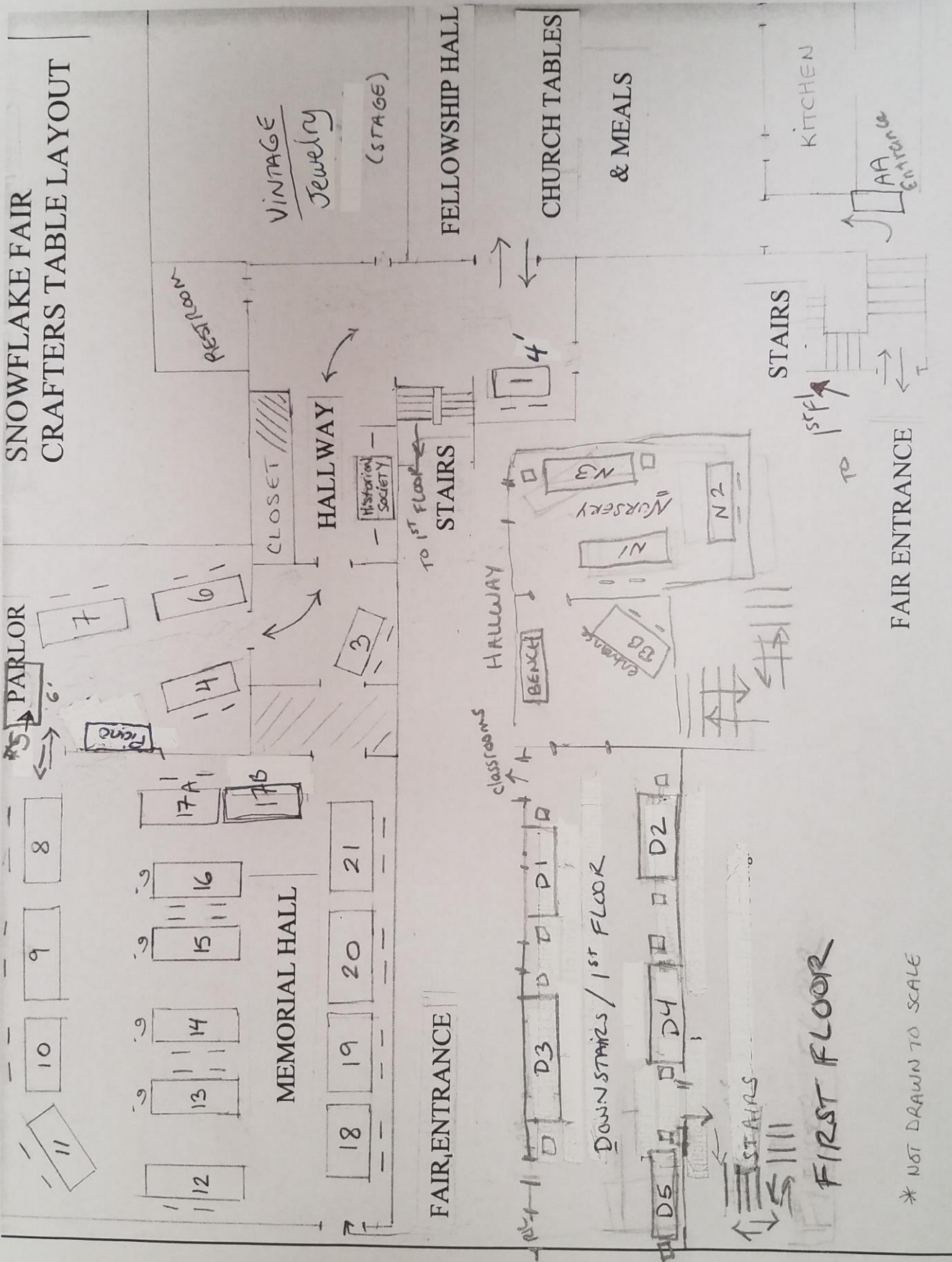

* NOT DRAWN TO SCALE

Snowflake Fair Application 2024

Please complete the following form and mail it in with your **non-refundable registration fee of \$10 - by August 16.** *

Name: _____ Phone: _____

Business name: _____ e-mail: _____

Address: _____ City, State, Zip: _____

Description of items being sold (Please attach a photo if you have not attended before):

TABLE PREFERENCES:

1) _____ 2) _____ 3) _____ 4) _____

PLEASE **CIRCLE** YOUR PREFERRED DATES TO ATTEND:

MAIN HALLWAY & PARLOR

\$50 for Friday Nov. 8 Only

\$50 for Saturday Nov. 9 Only

\$75 for **Both** Friday & Saturday

MEMORIAL HALL

\$40 for Friday Nov. 8 Only

\$40 for Saturday Nov. 9 Only

\$65 for **Both** Friday & Saturday

FIRST FLOOR HALLWAY & CLASSROOM

\$30 for Friday Nov. 8 Only

\$30 for Saturday Nov. 9 Only

\$50 for **Both** Friday & Saturday

ELECTRIC OUTLET NEEDED OWN SET-UP (bringing your own chairs and/or table)

*Checks Payable to Groveland Congregational Church

Please mail to: GCC, Attn: Amy Szarek, Snowflake Fair, GCC, 4 King St., Groveland, MA 01834

Questions? Contact Amy Szarek - call or text 978-380-2902 (for a quicker response)

email: mszarek@earthlink.net
